

SIERRA FOOTHILLS HORSEMAN'S ASSOCIATION

Sunday, August 28, 2016

Competitive "Judged" Trail Ride

Five age divisions!

Please do not bring dogs.

Arabian OEIP APPROVED!

Morgan OCP APPROVED!

Paint PAC APPROVED!

NEW!

TOP PLACING HORSE BREED AWARDS.

See list on entry form.



Ride to be held at: Foxworthy Ranch
9701 McCourtney Road, Lincoln

south of Camp Far West Lake – just across the road (*see map on back side of flyer*)

The Competitive Judged Trail Ride will test the ability of each horse/rider to maneuver through a series of natural trail obstacles (these may include: water crossing, weaving through trees/brush, log drag, picking up an object, mounting/dismounting, etc.) – trail ride is approximately 2 miles. Each obstacle will have its own judge who will individually score each horse/rider. At the conclusion of the ride, the scores from each individual judge will be tabulated per each horse/rider. Prizes and/or jackpot money will be awarded to the high places per each of the 5 age divisions (9 & under, 10-13, 14-17, 18-45, 46 & over).

START TIME FOR RIDE: Check-in starts at 7:00 a.m. (Riders' meeting at 7:30 a.m. for anyone who wants to participate.) Leave times for the ride start at 8:00 a.m. Small groups of riders will start ride every 15 minutes.

BBQ lunch is included with every paid entry.

Pre-registration required by **Aug 25, 2016**. Space/entries will be limited.

ENTER EARLY! Call Kim Foxworthy at (916) 276-3033

or e-mail: foxworthykim@yahoo.com

SFHA WEBSITE: www.thesfha.org (you can enter and pay on-line)

COMPETITIVE "JUDGED" TRAIL RIDE -- ENTRY FORM (one form per each horse and rider)

Sierra Foothills Horseman's Association (SFHA)

Sunday, Aug. 28, 2016

To be held at:

FOXWORTHY RANCH
9701 McCourtney Rd, Lincoln

NEW THIS YEAR: ADDITIONAL SEPARATE PRIZES WILL BE AWARDED FOR THE

- * HIGHEST PLACING **APPALOOSA** HORSE (sponsored by the Appaloosa Horse Club)
- * HIGHEST PLACING **ARABIAN** HORSE (sponsored by the Arabian Horse Association)
- * HIGHEST PLACING **MORGAN** HORSE (sponsored by the American Morgan Horse Association)
- * HIGHEST PLACING **PAINT** HORSE (sponsored by the American Paint Horse Association)
- * HIGHEST PLACING **PINTO** HORSE (sponsored by the Pinto Horse Association of America)
- * HIGHEST PLACING **QUARTER** HORSE (sponsored by the Pacific Coast Quarter Horse Association)

Horse must be registered in that breed association in order to be eligible to win the prize
(please attach a copy of the horse's registration papers to this entry form).

JUDGED ENTRY (rider's age as of 1/1/16):

JUDGED = Each obstacle will be judged. Top placings will win prizes!

_____ \$14.99 → Rider: 9 years and under – includes BBQ lunch

_____ \$14.99 → Rider: 10 years to 13 years – includes BBQ lunch

_____ \$35.00 → Rider: 14 years to 17 years – includes BBQ lunch AND the \$5.00 CA Drug Fee

_____ \$45.00 → Rider: 18 years to 45 years – includes BBQ lunch AND the \$5.00 CA Drug Fee

_____ \$45.00 → Rider: 46 years and over – includes BBQ lunch AND the \$5.00 CA Drug Fee

All of the entry fees listed above **INCLUDE** the BBQ lunch at the end of the ride. If you have extra people coming (non-riders) who would like to eat lunch, please indicate below and include payment.

_____ \$10.00 - **BBQ Lunch** per each "extra" person (non-rider)

+ a \$5.00 POST ENTRY FEE per rider if not entered BY AUG. 25th.

\$ _____ **TOTAL ENCLOSED** Enter on or before Aug. 25 to avoid post entry fee.

Make check payable to: SFHA. Mail to: Kim Foxworthy, 9701 McCourtney Rd, Lincoln 95648

To pay by debit or credit card (Pay Pal) - go to: www.thesfha.org

RIDER'S NAME: _____ PHONE: () _____

HORSE'S NAME: _____ AGE OF HORSE (as of 2016): _____

BREED OF HORSE: _____ REGISTRATION NUMBER: _____

MAILING ADDRESS: _____

CITY, STATE, and ZIP: _____

E-MAIL ADDRESS: _____

EACH RIDER MUST SIGN A LIABILITY RELEASE FORM DAY OF RIDE. IF RIDER IS UNDER 18 YEARS OF AGE, A PARENT OR GUARDIAN MUST SIGN LIABILITY RELEASE FORM INDICATING ACCEPTANCE OF ALL RESPONSIBILITY OF SAID MINOR. ALL HORSES RIDDEN ON RIDE OR IN THE AREA MUST BE ENTERED IN THIS RIDE – ENTRY FORM MUST BE FILLED OUT/ ENTRY FEES PAID. NOTE: NO REFUNDS WILL BE GIVEN. DOGS MUST BE ON LEASH AT ALL TIMES.

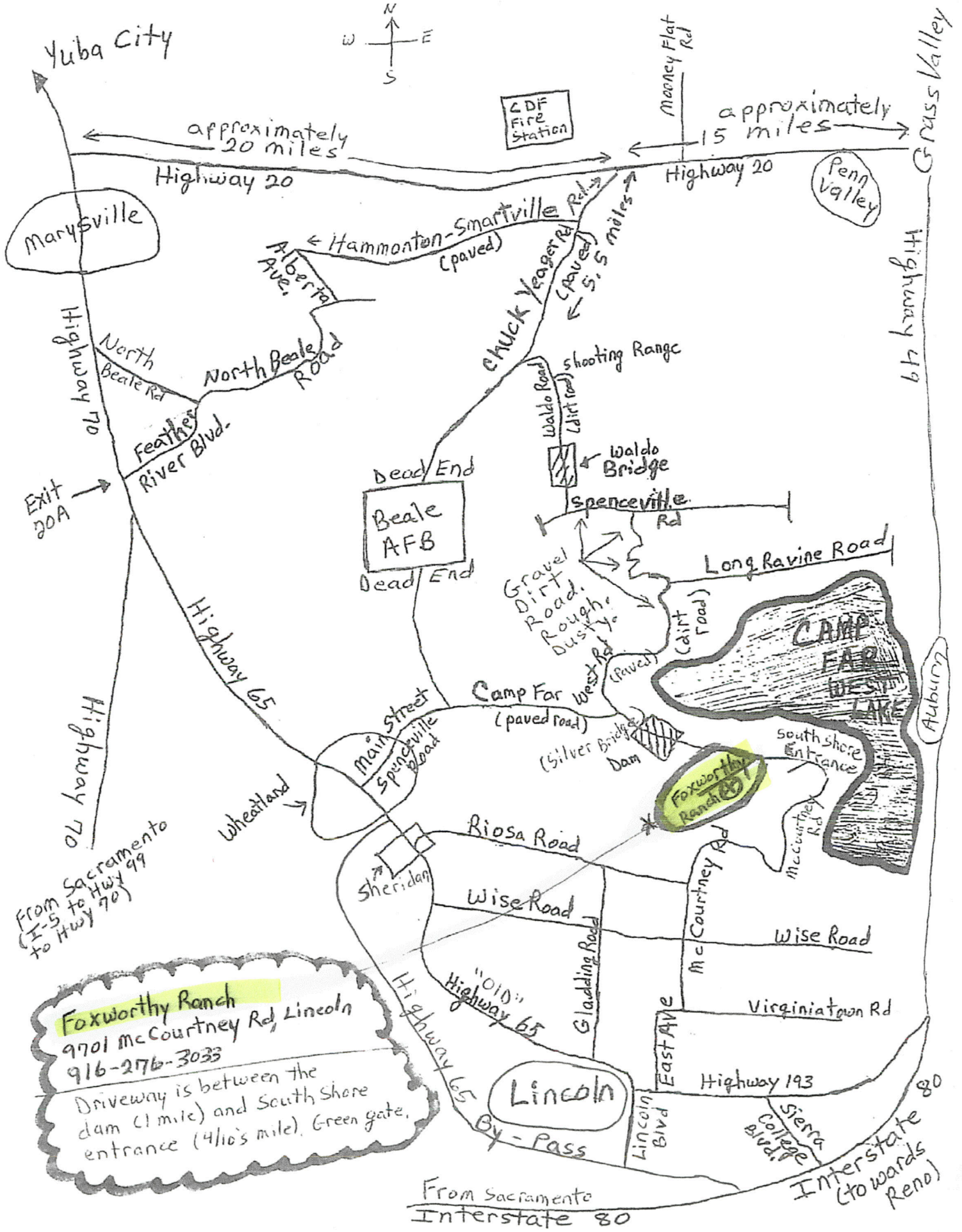

Foxworthy Ranch
 9701 McCourtney Rd, Lincoln
 916-276-3033

Driveway is between the dam (1 mile) and South Shore entrance (4 1/2 mile). Green gate.